



ASPIRE

— TO MOVE —



Abbey Green, Bath, BA1

Video and physical viewings available. Top floor, unfurnished, one bedroom flat located in a central position within bath city centre. Available from the 27th July.

Abbey Green is located in the heart of the city centre with views of the attractive square and Bath Abbey making it perfect for sitting in the window seat enjoying a glass of wine. The location offers great access to local amenities and the train station located 0.3 miles away.

£1,195 PCM

Abbey Green, Bath, BA1

- One bedroom flat
- Available 27th July
- Holding deposit: £275
- Top floor
- Central location
- Unfurnished
- Council tax band B

Video and physical viewings available. Top floor, unfurnished, one bedroom flat located in a central position within bath city centre. Available 27th July.

Abbey Green is located in the heart of the city centre with views of the attractive square and Bath Abbey making it perfect for sitting in the window seat enjoying a glass of wine. The location offers great access to local amenities and the train station located 0.3 miles away.

This charming top floor apartment is situated in a handsome Georgian Grade II listed building adjacent to the Roman Baths and Bath Abbey. A beautiful stairwell winds up to the top landing. Once inside the apartment the sitting room overlooks the historic cobbled Abbey Green with its ancient plane tree.

There is a double bedroom and a good sized, recently refitted kitchen and bathroom. The flat has been newly decorated throughout. The kitchen has base units, oven, hob and undercounter fridge. There is a breakfast bar area with two stools for seating. Please note the landlord is looking into supplying a washing machine. The living room has plenty of space for sofa and coffee table, and the bedroom is located off of this room.

The flat is available 27th July and offered unfurnished. The flat would best suit a single professional or couple.

Council tax band B: £1808.54

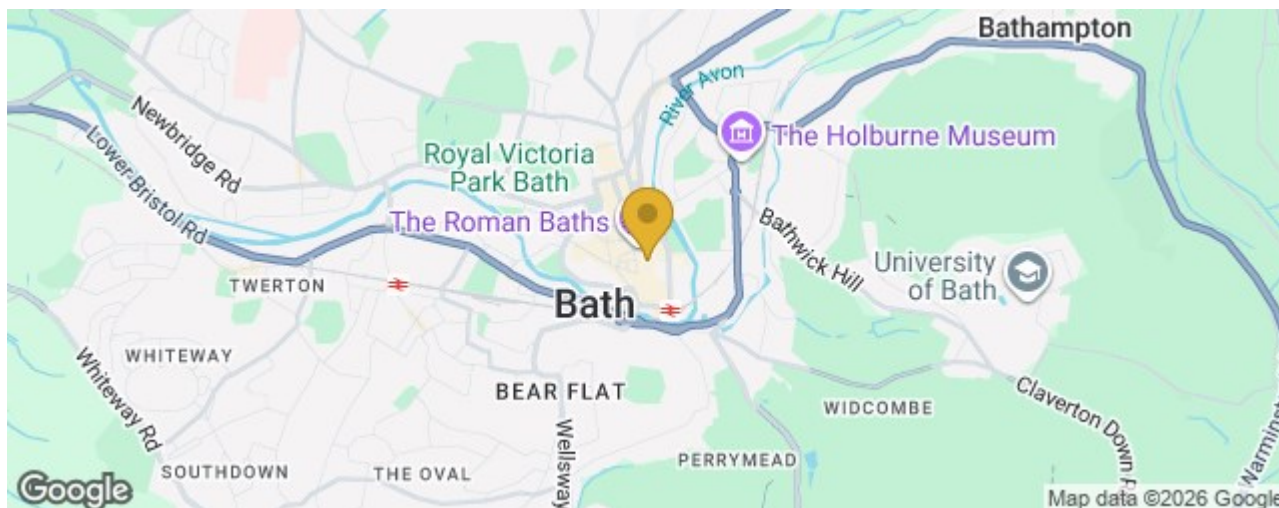



TOP FLOOR
398 sq.ft. (37.0 sq.m.) approx.

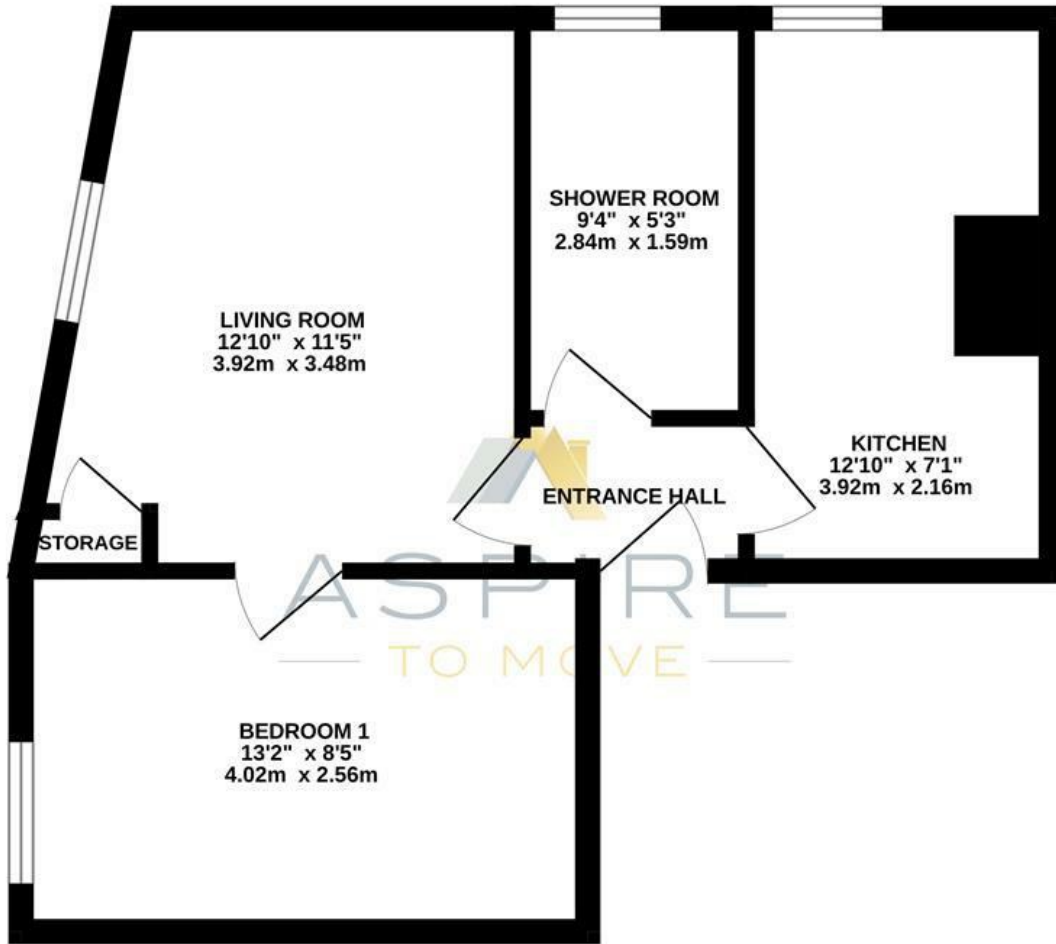

ABBAY HOUSE, BATH, BA1

TOTAL FLOOR AREA: 398 sq.ft. (37.0 sq.m.) approx.

Whilst every attempt has been made to ensure the accuracy of the floorplan contained here, measurements of doors, windows, rooms and any other items are approximate and no responsibility is taken for any error, omission or mis-statement. This plan is for illustrative purposes only and should be used as such by any prospective purchaser. The services, systems and appliances shown have not been tested and no guarantee as to their operability or efficiency can be given.
Made with Metropix C2025

These particulars, whilst believed to be accurate are set out as a general outline only for guidance and do not constitute any part of an offer or contract. Intending purchasers should not rely on them as statements of representation of fact, but must satisfy themselves by inspection or otherwise as to their accuracy. No person in this firm's employment has the authority to make or give any representation or warranty in respect of the property.

